



Put all parts of the frame and your photo or document on a flat, clean surface in front of you.



Remove the protective foil from **both** of each acrylic part of the frame.



Put the back part of your frame on your surface. Make sure all magnetic pins are inserted with their heads pointing downwards.

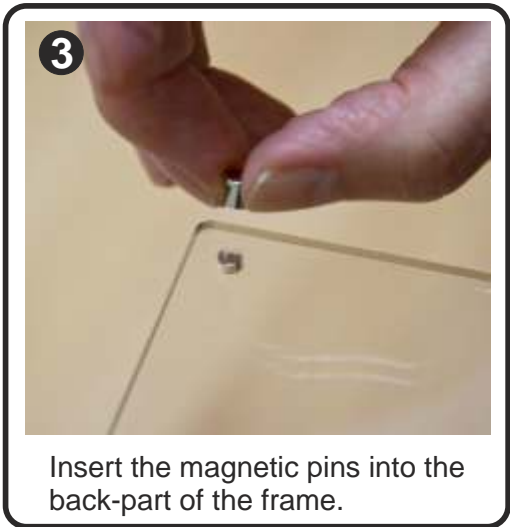

Insert the magnetic pins into the back-part of the frame.



After aligning your photo / document on the back part of the frame, place the front part carefully on top of it. Insert the remaining magnetic pins ... and you are done!

Cleaning instructions :
 Please do not use any cleaning agents other than water or special acrylic care products. Many other cleaning agents contain solvents, which can damage the acrylic glass.
 If you have any further questions, please contact us by e-mail or telephone.

Individual Parts :
 5 x Magnetic Pin 4mm shaft length with **north** -> **south** polarity
 5 x Magnetic Pin 4mm shaft length with **south** -> **north** polarity

front part and back part for frame without wall mounting	back part for frame with traverse wall mounting	back part for frame with upright wall mounting
--	--	--

Your frame looks different? Don't worry, this is a sample construction manual for different types of magnetic frames.

Sora-Shop.com
 Am Schunkenhofe 11
 D-99848 Wutha-Farnroda
 info@sorashowcases.com

Business hours :
 Mo - Th. 09:00 a.m. - 04:00 p.m.
 Fr. 09:00 a.m. - 11:00 p.m.
 +49 36921 914 11